

RESOLUTION NO. 51

A RESOLUTION ADOPTING THE
TONTITOWN LAND USE PLAN MAP

WHEREAS, the Tontitown Planning Commission, with the assistance of the Northwest Arkansas Regional Planning Commission (NWARPC), has studied the existing land use patterns of the City of Tontitown, Arkansas and prepared a map showing the Land Use Plan, and

WHEREAS, on March 15, 1990 the Tontitown Planning Commission, after the required publication and notification, presented the Land Use Plan map in a public hearing on the Land Use Plan, and

WHEREAS, the Tontitown Planning Commission, on April 12, 1990 discussed the plan presented in the public hearing, voted to adopt the Tontitown Land Use Plan map and, by resolution, recommend it's adoption by the Tontitown City Council, with the following changes: On North Barrington Road from Residential/Office to Residential/Commercial, and extend the Commercial on Highway 412 East to Jones Road.

NOW THEREFORE BE IT RESOLVED BY THE CITY COUNCIL OF TONTITOWN,
ARKANSAS

THAT the Tontitown Land Use Plan map be hereby adopted by the City of Tontitown, Arkansas.

PASSED this 5th day of June, 1990.

Freddie B. Faldo
Chairman

ATTEST:

Frances Franco
Secretary

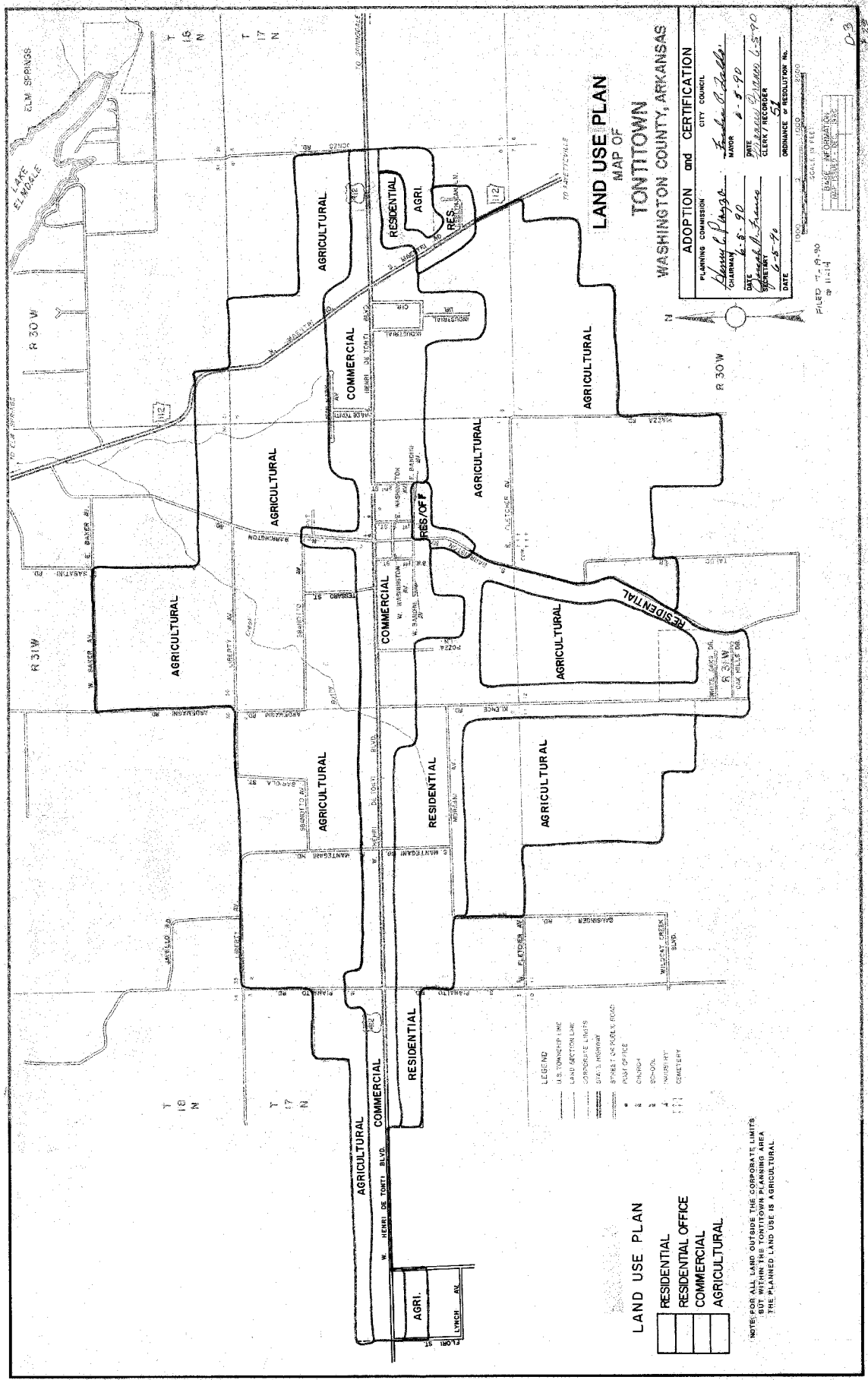

LAND USE PLAN
MAP OF
TONTITOWN
WASHINGTON COUNTY, ARKANSAS

ADOPTION and CERTIFICATION
 CITY COUNCIL
 PLANNING COMMISSION
 CHAIRMAN: *Harry C. Pargo*
 DATE: *6-8-90*
 SECRETARY: *George H. Francis*
 DATE: *6-5-90*
 MADE BY: *Franklin C. Stubb*
 DATE: *6-5-90*
 CLERK/RECORDER: *W. Travis D. Miller*
 DATE: *6-5-90*
 ORDINANCE OR RESOLUTION NO. _____



FILED T. 19-30
 P. 11-14
 SCALE: 1" = 100'
 DATE: _____
 BY: _____

- LEGEND**
- U.S. TOWNSHIP LINE
 - LAND SECTION LINE
 - CORPORATE LIMITS
 - STATE HIGHWAY
 - STREET CAR/RAIL ROAD
 - CITY OFFICE
 - CHURCH
 - SCHOOL
 - POWER HT.
 - CEMETERY

LAND USE PLAN

- RESIDENTIAL
- RESIDENTIAL OFFICE
- COMMERCIAL
- AGRICULTURAL

NOTE: FOR ALL LAND OUTSIDE THE CORPORATE LIMITS
 BUT WITHIN THE TOWNSHIP AREA
 THE PLANNED LAND USE IS AGRICULTURAL