



Fence Permit Application:

Permit #: _____

FENCE PERMITS ARE REQUIRED FOR ALL FENCES

There is no additional charge for the fence permit
if in conjunction with a new residential permit.

NOTE: Must Submit Site Plan with Application

Fee: \$ _____

Receipt#: _____

Approved By: _____

Date approved: _____

Site Information:

Site Address:	
Subdivision:	Lot # (if known):

General Contractor OR Site / Property Owners Information:

Name:	Phone #:
Mailing Address:	Email:

Sub/Contractor's Information:

Business Name:	Phone #:
Mailing Address:	Email:
Contact Person:	Phone #:
Master Lic#:	Exp Date:

General Information:

Type of Fence: Check all that apply	<input type="checkbox"/> New Residential	<input type="checkbox"/> Front Yard	<input type="checkbox"/> Interior Lot	<input type="checkbox"/> Other (list):
	<input type="checkbox"/> Add. to Existing Fence	<input type="checkbox"/> Back Yard	<input type="checkbox"/> Corner Lot	
	<input type="checkbox"/> Exist Res/New Fence	<input type="checkbox"/> Replacement	<input type="checkbox"/> Commercial	
Description of Work:				
Value of Commercial (Materials & Labor):				

Type of Materials: Check all that apply	<input type="checkbox"/> Chain Link	<input type="checkbox"/> Wood Privacy	<input type="checkbox"/> Wrought Iron	<input type="checkbox"/> Other (list):
	<input type="checkbox"/> Retaining Wall	<input type="checkbox"/> Brick	<input type="checkbox"/> Other Masonry	
Will the fence enclose a pool or hot tub?				
Height of fence (in feet):				

A plot plan must be submitted. The plot plan must include the following information:

<input type="checkbox"/> Location of all property lines	<input type="checkbox"/> Location of new fencing	<input type="checkbox"/> Location of all existing structures
<input type="checkbox"/> Location of gates	<input type="checkbox"/> Location of existing or proposed pools or spas	<input type="checkbox"/> Location of utility easements
<input type="checkbox"/> Location of drainage easements	<input type="checkbox"/> Portions of existing fence that will be replaced	<input type="checkbox"/> Location of existing fencing on or adjacent to the property that is to remain in place

FENCE REGULATIONS: *additional regulations apply to some Commercial/Industrial Uses-check full code*

153.215 FENCES.

Except as otherwise specifically provided in other codes and regulations of the city, the following regulations shall apply to the construction of all fences.

- (A) *Maximum height.* Fences shall not exceed eight feet in height, unless approved by the Planning Commission. Fencing in I districts, and around tennis courts and other recreational amenities, shall be exempt from this height limit.
- (B) *Corner visibility.* Fences shall comply with the corner visibility standards of § [153.213](#).
- (C) *Construction/materials.* Fences in all residential zoning districts shall be constructed so that the horizontal and vertical support posts are inside the fenced area or hidden from view of those outside the fenced area. This requirement shall not apply to fences that abut nonresidential zoning districts or in situations where the owner of the lot adjacent to the fence agrees to a plan for placing support posts on the "outside" of the fence. All exposed steel, except galvanized metal, shall have a color finish coat applied to them and be preserved against rust and corrosion.
- (D) *Design and maintenance.* All fences shall be maintained in their original upright condition. Fences designed to be painted or have other surface finishes shall be maintained in their original condition as designed. Missing boards, pickets, or posts shall be replaced in a timely manner with material of the same type and quality.
- (E) *Prohibited.* Barbed wire and electrified fences shall be prohibited on all lots of less than one acres in area.
- (F) *Front yard.* Unless approved by the Planning board, a fence over 36 inches in height shall not be located in the front yard or be positioned any closer to the front property line than the front surface of the building for a typical residential lot. Decorative fencing not exceeding 36 inches is allowed in front yards.
- (G) *Pools and spas.* Refer to International Building Code, Swimming Pool Enclosures and Safety Devices.

Also see illustrations:

- Fences must be located at least 5' from street or public right-of-way.
- No fence may be located within a sight triangle
- Fences may not be located in a platted drainage easement.

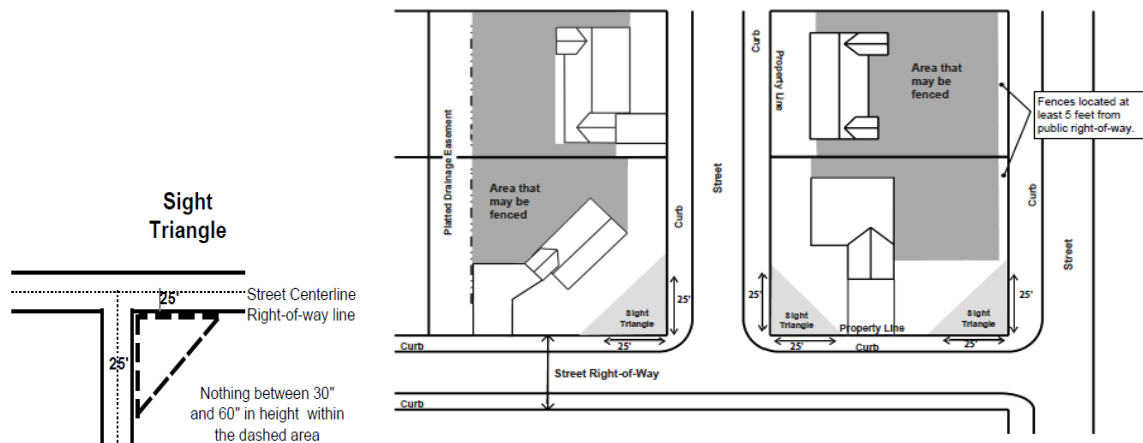

This permit is issued with a hold harmless agreement with the City of Tontitown for any damage from Arkansas State Law Title 14-SubTitle16-Chapter271. "Arkansas Underground Facilities Damage Prevention Act." Also known as 811 – Arkansas One Call.

This permit becomes null and void if work or construction authorized is not commenced within 6 months, or if construction or work is suspended or abandoned for a period of 6 months at any time after work is commenced.

I hereby certify that I have read and examined this application and know the same to be true and correct. All provisions of laws and ordinances governing this type of work will be complied with whether specified herein or not. The granting of a permit does not presume to give authority to violate or cancel the provisions of any other state or local law regulating construction or the performance of construction.

Permit fees will double if work begins before permit is approved and/or if lines are covered before inspection has passed. Requests for inspections may be made either by emailing maintenance@tontitownar.gov or calling 479-263-9215.

Signature of Owner or Contractor: _____

Date: _____